

levelling elements in polyamide series K



levelling elements in polyamide series K

These elements meet special requirements for vibration isolation and levelling, chiefly for (but not limited to) application with

- special purpose machinery
- beverage processing
- food processing
- packaging technology
- chemical and laboratory equipment

product highlights



ample pendulum action
(appr. 15°)



spheric pendulum ballhead and thread
in stainless steel



elastomer NBR
with non-slip pattern



holes
for floor-anchoring (optional)

The levelling element consists of a base plate of reinforced polyamide, as well as a levelling screw and inter-connecting spheric pendulum, both made of stainless steel. The patterned non-slip and isolation plate (NBR, 70 Shore) at the bottom is persistent towards water, mineral oils, fuels, alkaline and acidic solutions, soap-based lyes, salts and detergents. Other shore hardness / elastomer thickness on request.

Diameters of 50 mm, 80 mm, 100 mm and 120 mm, modular-variable net thread lengths and loads ranging from 300 daN up to 1500 daN. Version 'B' with holes for floor-anchoring (except element size K 5).

optional:
delivery with nuts and washers (to be ordered separately)
ready-packed and labelled sets as per customer guideline

Ideally suited for combined application with threaded square or round tube inserts (also available from us).

levelling elements in polyamide

K 5

Ø 50 mm

| metal components stainless steel | | Ø | M | key width SW | H | L | H ₁ | shore hardness | load |
|-------------------------------------|----------------|----|-----|--------------|-----|-----|----------------|----------------|----------|
| description | article number | mm | | mm | mm | mm | mm | ±5 Shore | max. daN |
| K5/M10x50/NBR7011 | 9003 0035 | 50 | M10 | 17 | 89 | 50 | 39 | 70 | 300 |
| K5/M10x100/NBR7011 | 9003 0001 | 50 | M10 | 17 | 139 | 100 | 39 | 70 | 300 |
| K5/M10x150/NBR7011 | 9003 0036 | 50 | M10 | 17 | 189 | 150 | 39 | 70 | 300 |
| K5/M10x200/NBR7011 | 9003 0037 | 50 | M10 | 17 | 239 | 200 | 39 | 70 | 300 |
| K5/M12x50/NBR7011 | 9003 0038 | 50 | M12 | 19 | 89 | 50 | 39 | 70 | 300 |
| K5/M12x100/NBR7011 | 9003 0002 | 50 | M12 | 19 | 139 | 100 | 39 | 70 | 300 |
| K5/M12x150/NBR7011 | 9003 0039 | 50 | M12 | 19 | 189 | 150 | 39 | 70 | 300 |
| K5/M12x200/NBR7011 | 9003 0040 | 50 | M12 | 19 | 239 | 200 | 39 | 70 | 300 |



K5/M10x100



K5/M12x100



bottom view K 5

| thread | standard thread lengths | | | | | |
|--------|-------------------------|-----|-----|-----|------|------|
| | L | | | | | |
| | in mm | | | | | |
| M 10 | 50 | 100 | 150 | 200 | *250 | *300 |
| M 12 | 50 | 100 | 150 | 200 | *250 | *300 |

measurement L of the levelling screw relates to the net thread length

optional: special- and intermediate thread lengths

* on request

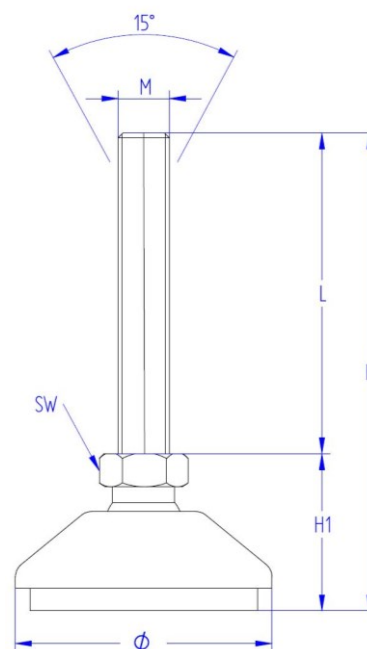

levelling elements in polyamide

K 8

Ø 80 mm

| metal components stainless steel | | Ø | M | key width SW | H | L | H ₁ | shore hardness | load |
|-------------------------------------|----------------|----|-----|--------------|-----|-----|----------------|----------------|----------|
| description | article number | mm | | mm | mm | mm | mm | ±5 Shore | max. daN |
| K8/M12x50/NBR7011 | 9003 0041 | 80 | M12 | 24 | 98 | 50 | 48 | 70 | 650 |
| K8/M12x100/NBR7011 | 9003 0005 | 80 | M12 | 24 | 148 | 100 | 48 | 70 | 650 |
| K8/M12x150/NBR7011 | 9003 0032 | 80 | M12 | 24 | 198 | 150 | 48 | 70 | 650 |
| K8/M12x200/NBR7011 | 9003 0034 | 80 | M12 | 24 | 248 | 200 | 48 | 70 | 650 |
| K8/M16x100/NBR7011 | 9003 0006 | 80 | M16 | 24 | 149 | 100 | 49 | 70 | 650 |
| K8/M16x150/NBR7011 | 9003 0031 | 80 | M16 | 24 | 199 | 150 | 49 | 70 | 650 |
| K8/M16x200/NBR7011 | 9003 0042 | 80 | M16 | 24 | 249 | 200 | 49 | 70 | 650 |
| K8/M16x250/NBR7011 | 9003 0043 | 80 | M16 | 24 | 299 | 250 | 49 | 70 | 650 |



K8/M12x100



K8/M16x100



bottom view K 8

| thread | standard thread lengths | | | | | |
|--------|-------------------------|-----|-----|-----|------|------|
| | L | | | | | |
| | in mm | | | | | |
| M 12 | 50 | 100 | 150 | 200 | *250 | *300 |
| M 16 | *50 | 100 | 150 | 200 | 250 | *300 |

measurement L of the levelling screw relates to the net thread length

optional: special- and intermediate thread lengths

* on request

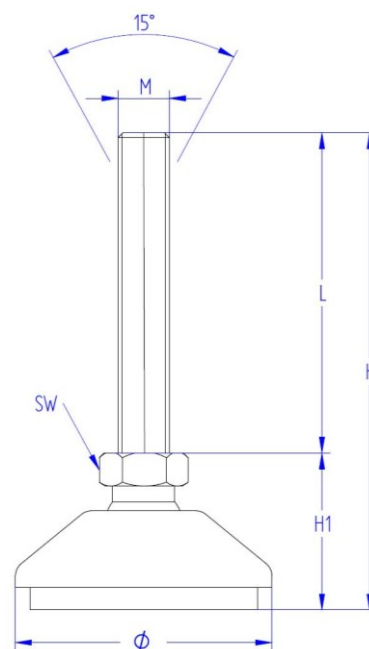

levelling elements in polyamide

K 8/B

Ø 80 mm - with holes for floor-anchoring

| metal components stainless steel | | Ø | M | key width SW | H | L | H ₁ | floor-anchoring holes | shore hardness | load |
|-------------------------------------|----------------|----|-----|-----------------|-----|-----|----------------|-----------------------|----------------|----------|
| description | article number | mm | | mm | mm | mm | mm | Ø mm | ±5 Shore | max. daN |
| K8/B/M12x50/NBR7011 | 9003 0044 | 80 | M12 | 24 | 98 | 50 | 48 | 9 | 70 | 650 |
| K8/B/M12x100/NBR7011 | 9003 0011 | 80 | M12 | 24 | 148 | 100 | 48 | 9 | 70 | 650 |
| K8/B/M12x150/NBR7011 | 9003 0045 | 80 | M12 | 24 | 198 | 150 | 48 | 9 | 70 | 650 |
| K8/B/M12x200/NBR7011 | 9003 0046 | 80 | M12 | 24 | 248 | 200 | 48 | 9 | 70 | 650 |
| K8/B/M16x100/NBR7011 | 9003 0012 | 80 | M16 | 24 | 149 | 100 | 49 | 9 | 70 | 650 |
| K8/B/M16x150/NBR7011 | 9003 0047 | 80 | M16 | 24 | 199 | 150 | 49 | 9 | 70 | 650 |
| K8/B/M16x200/NBR7011 | 9003 0048 | 80 | M16 | 24 | 249 | 200 | 49 | 9 | 70 | 650 |
| K8/B/M16x250/NBR7011 | 9003 0049 | 80 | M16 | 24 | 299 | 250 | 49 | 9 | 70 | 650 |



K8/B/M12x100



K8/B/M16x100



bottom view K 8/B

| thread | standard thread lengths | | | | | |
|--------|-------------------------|-----|-----|-----|------|------|
| | L | | | | | |
| | in mm | | | | | |
| M 12 | 50 | 100 | 150 | 200 | *250 | *300 |
| M 16 | *50 | 100 | 150 | 200 | 250 | *300 |

measurement L of the levelling screw relates to the net thread length

optional: special- and intermediate thread lengths

* on request

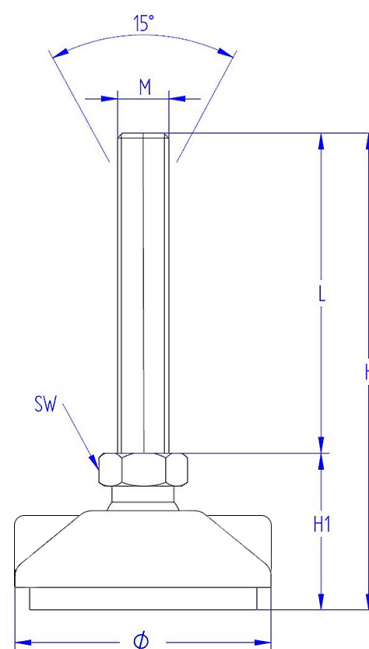

levelling elements in polyamide

K 10

Ø 100 mm

| metal components stainless steel | | Ø | M | key width SW | H | L | H ₁ | shore hardness | load |
|-------------------------------------|----------------|-----|-----|--------------|-----|-----|----------------|----------------|----------|
| description | article number | mm | | mm | mm | mm | mm | ±5 Shore | max. daN |
| K10/M16x100/NBR7011 | 9003 0007 | 100 | M16 | 24 | 151 | 100 | 51 | 70 | 800 |
| K10/M16x150/NBR7011 | 9003 0050 | 100 | M16 | 24 | 201 | 150 | 51 | 70 | 800 |
| K10/M16x200/NBR7011 | 9003 0051 | 100 | M16 | 24 | 251 | 200 | 51 | 70 | 800 |
| K10/M16x250/NBR7011 | 9003 0052 | 100 | M16 | 24 | 301 | 250 | 51 | 70 | 800 |
| K10/M20x100/NBR7011 | 9003 0008 | 100 | M20 | 30 | 151 | 100 | 51 | 70 | 800 |
| K10/M20x150/NBR7011 | 9003 0053 | 100 | M20 | 30 | 201 | 150 | 51 | 70 | 800 |
| K10/M20x200/NBR7011 | 9003 0054 | 100 | M20 | 30 | 251 | 200 | 51 | 70 | 800 |
| K10/M20x250/NBR7011 | 9003 0055 | 100 | M20 | 30 | 301 | 250 | 51 | 70 | 800 |
| K10/M20x300/NBR7011 | 9003 0072 | 100 | M20 | 30 | 351 | 300 | 51 | 70 | 800 |



K10/M16x100



K10/M20x100



bottom view K 10

| thread | standard thread lengths | | | | | |
|--------|-------------------------|-----|-----|-----|-----|------|
| | L | | | | | |
| | in mm | | | | | |
| M 16 | *50 | 100 | 150 | 200 | 250 | *300 |
| M 20 | *50 | 100 | 150 | 200 | 250 | 300 |

measurement L of the levelling screw relates to the net thread length

optional: special- and intermediate thread lengths

* on request

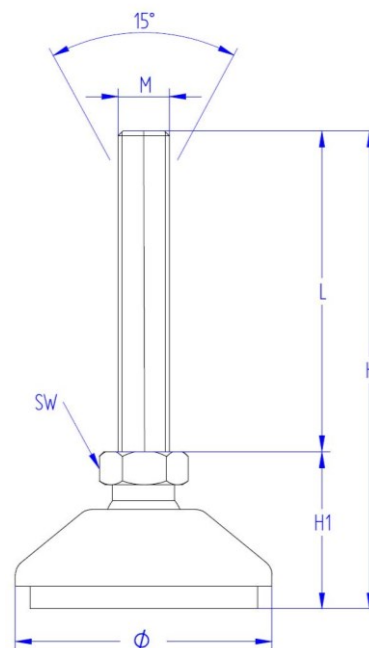

levelling elements in polyamide

K 10/B

Ø 100 mm - with holes for floor-anchoring

| metal components stainless steel | | Ø | M | key width SW | H | L | H ₁ | floor-anchoring holes | shore hardness | load |
|-------------------------------------|----------------|-----|-----|-----------------|-----|-----|----------------|-----------------------|----------------|----------|
| description | article number | mm | | mm | mm | mm | mm | Ø mm | ±5 Shore | max. daN |
| K10/B/M16x100/NBR7011 | 9003 0013 | 100 | M16 | 24 | 151 | 100 | 51 | 13 | 70 | 800 |
| K10/B/M16x150/NBR7011 | 9003 0056 | 100 | M16 | 24 | 201 | 150 | 51 | 13 | 70 | 800 |
| K10/B/M16x200/NBR7011 | 9003 0057 | 100 | M16 | 24 | 251 | 200 | 51 | 13 | 70 | 800 |
| K10/B/M16x250/NBR7011 | 9003 0058 | 100 | M16 | 24 | 301 | 250 | 51 | 13 | 70 | 800 |
| K10/B/M20x100/NBR7011 | 9003 0014 | 100 | M20 | 30 | 151 | 100 | 51 | 13 | 70 | 800 |
| K10/B/M20x150/NBR7011 | 9003 0024 | 100 | M20 | 30 | 201 | 150 | 51 | 13 | 70 | 800 |
| K10/B/M20x200/NBR7011 | 9003 0059 | 100 | M20 | 30 | 251 | 200 | 51 | 13 | 70 | 800 |
| K10/B/M20x250/NBR7011 | 9003 0060 | 100 | M20 | 30 | 301 | 250 | 51 | 13 | 70 | 800 |
| K10/B/M20x300/NBR7011 | 9003 0073 | 100 | M20 | 30 | 351 | 300 | 51 | 13 | 70 | 800 |



K10/B/M16x100



K10/B/M20x100



bottom view K 10/B

| thread | standard thread lengths | | | | | |
|--------|-------------------------|-----|-----|-----|-----|------|
| | L | | | | | |
| | in mm | | | | | |
| M 16 | *50 | 100 | 150 | 200 | 250 | *300 |
| M 20 | *50 | 100 | 150 | 200 | 250 | 300 |

measurement L of the levelling screw relates to the net thread length

optional: special- and intermediate thread lengths

* on request

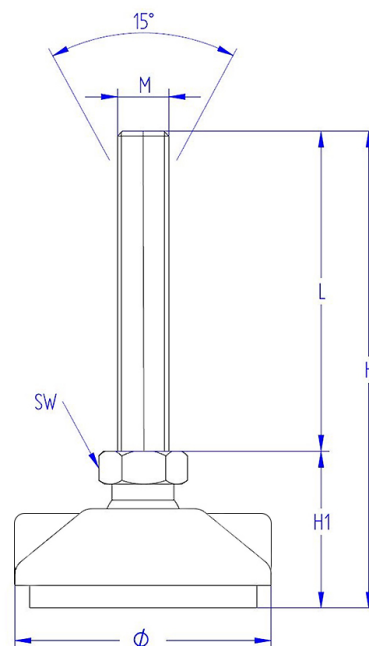

levelling elements in polyamide

K 12

Ø 120 mm

| metal components stainless steel | | Ø | M | key width SW | H | L | H ₁ | shore hardness | load |
|-------------------------------------|----------------|-----|-----|--------------|-----|-----|----------------|----------------|----------|
| description | article number | mm | | mm | mm | mm | mm | ±5 Shore | max. daN |
| K12/M16x100/NBR7011 | 9003 0009 | 120 | M16 | 24 | 151 | 100 | 51 | 70 | 1500 |
| K12/M16x150/NBR7011 | 9003 0061 | 120 | M16 | 24 | 201 | 150 | 51 | 70 | 1500 |
| K12/M16x200/NBR7011 | 9003 0025 | 120 | M16 | 24 | 251 | 200 | 51 | 70 | 1500 |
| K12/M16x250/NBR7011 | 9003 0062 | 120 | M16 | 24 | 301 | 250 | 51 | 70 | 1500 |
| K12/M20x100/NBR7011 | 9003 0010 | 120 | M20 | 30 | 151 | 100 | 51 | 70 | 1500 |
| K12/M20x150/NBR7011 | 9003 0063 | 120 | M20 | 30 | 201 | 150 | 51 | 70 | 1500 |
| K12/M20x200/NBR7011 | 9003 0064 | 120 | M20 | 30 | 251 | 200 | 51 | 70 | 1500 |
| K12/M20x250/NBR7011 | 9003 0065 | 120 | M20 | 30 | 301 | 250 | 51 | 70 | 1500 |
| K12/M20x300/NBR7011 | 9003 0074 | 120 | M20 | 30 | 351 | 300 | 51 | 70 | 1500 |



K12/M16x100



K12/M20x100



bottom view K 12

| thread | standard thread lengths | | | | | |
|--------|-------------------------|-----|-----|-----|-----|------|
| | L | | | | | |
| | in mm | | | | | |
| M 16 | *50 | 100 | 150 | 200 | 250 | *300 |
| M 20 | *50 | 100 | 150 | 200 | 250 | 300 |

measurement L of the levelling screw relates to the net thread length

optional: special- and intermediate thread lengths

* on request

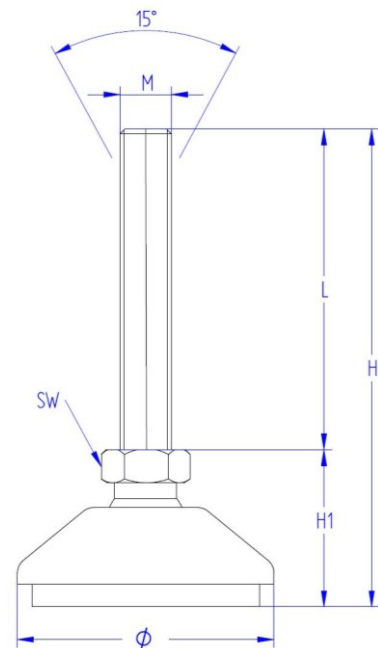

levelling elements in polyamide

K 12/B

Ø 120 mm - with holes for floor-anchoring

| metal components stainless steel | | Ø | M | key width SW | H | L | H ₁ | floor-anchoring holes | shore hardness | load |
|-------------------------------------|----------------|-----|-----|-----------------|-----|-----|----------------|-----------------------|----------------|----------|
| description | article number | mm | | mm | mm | mm | mm | Ø mm | ±5 Shore | max. daN |
| K12/B/M16x100/NBR7011 | 9003 0015 | 120 | M16 | 24 | 151 | 100 | 51 | 11 | 70 | 1500 |
| K12/B/M16x150/NBR7011 | 9003 0066 | 120 | M16 | 24 | 201 | 150 | 51 | 11 | 70 | 1500 |
| K12/B/M16x200/NBR7011 | 9003 0067 | 120 | M16 | 24 | 251 | 200 | 51 | 11 | 70 | 1500 |
| K12/B/M16x250/NBR7011 | 9003 0068 | 120 | M16 | 24 | 301 | 250 | 51 | 11 | 70 | 1500 |
| K12/B/M20x100/NBR7011 | 9003 0016 | 120 | M20 | 30 | 151 | 100 | 51 | 11 | 70 | 1500 |
| K12/B/M20x150/NBR7011 | 9003 0069 | 120 | M20 | 30 | 201 | 150 | 51 | 11 | 70 | 1500 |
| K12/B/M20x200/NBR7011 | 9003 0070 | 120 | M20 | 30 | 251 | 200 | 51 | 11 | 70 | 1500 |
| K12/B/M20x250/NBR7011 | 9003 0071 | 120 | M20 | 30 | 301 | 250 | 51 | 11 | 70 | 1500 |
| K12/B/M20x300/NBR7011 | 9003 0075 | 120 | M20 | 30 | 351 | 300 | 51 | 11 | 70 | 1500 |



K12/B/M16x100



K12/B/M20x100



bottom view K 12/B

| thread | standard thread lengths | | | | | |
|--------|-------------------------|-----|-----|-----|-----|------|
| | L | | | | | |
| | in mm | | | | | |
| M 16 | *50 | 100 | 150 | 200 | 250 | *300 |
| M 20 | *50 | 100 | 150 | 200 | 250 | 300 |

measurement L of the levelling screw relates to the net thread length

optional: special- and intermediate thread lengths

* on request

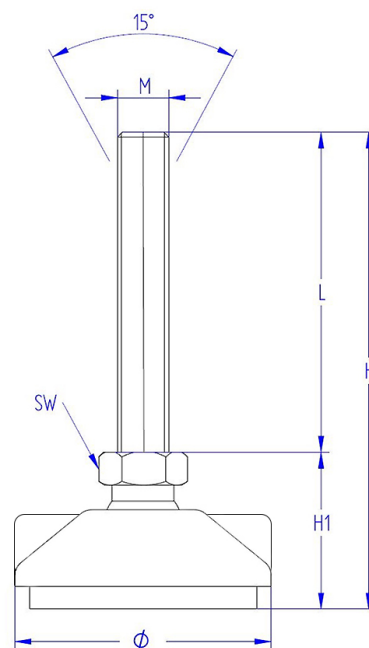

Technical modifications subject to change! Any previous versions of this document are herewith null and void!